

MOD: XF133-B

EXPLODED VIEW DISEGNO ESPLOSO

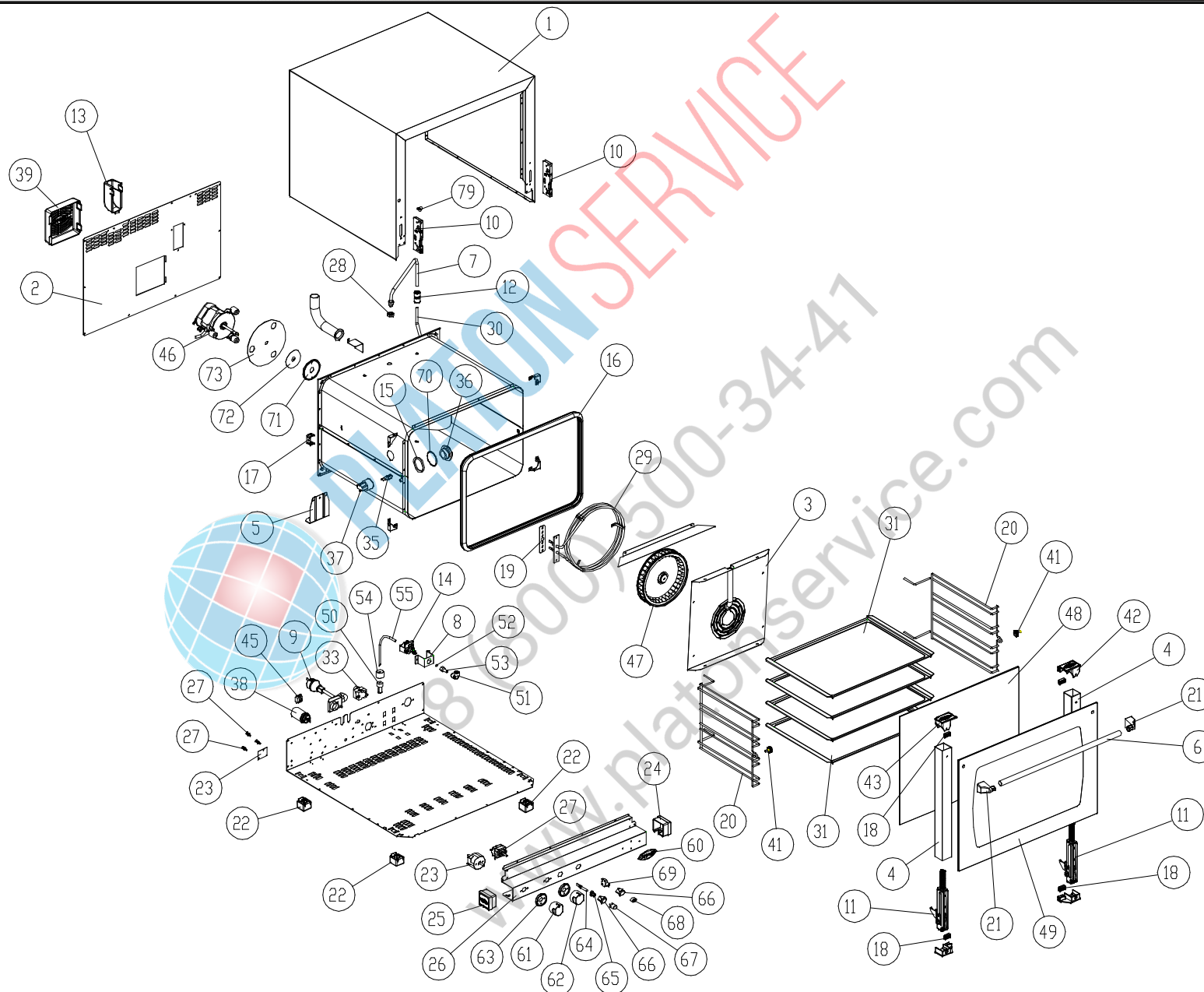

DESCRIZIONE CODICI

1	OD1275B0
2	OFI085B0
3	OG1112B0 CARTER ARIA INOX L.M. ARIANNA MANUAL
4	OH1425B0 COLONNINA SX/DX L.M. ARIA-ROSSEL 40x40x1
5	OH1455A1 STAFFA SOSTEGNO MUFFOLA L.M.
6	OH1925B0 TUBO MANIGLIA L= 518 Ø18x1
7	OH1990A1 TUBO ESTERNO UMIDITA + RACCORDO RCT165A0
8	OH3743A0 SUPPORTO POMPA ULKA
9	MRI000A0 CAVO 3X1,5 H07RN-F MTT,5+K2/3+SCHUKO
10	CR1000A0 ATTACCO CERNIERA PORTA FORNO RIBALTA
11	CR1015A0 CERNIERA PORTA FORNO RIBALTA L.M.
12	ELI055A0 RIDUZIONE J.G. DA D=10 A D=8 PM201008E
13	VM1951A0 CUFFIA COPRICAMMINO IP
14	PM1000A0 POMPA ULKA NMEIC+ATT SUPERIORE 10M
15	GN1065A1 GUARNIZIONE PORTALAMPADA DE=53.2
16	GN1110A2 GUARNIZIONE PORTA PROFILO 248
17	OH4820A0 STAFFA SOSTEGNO BULBO
18	GN1130A0 GUARNIZIONE SUPPORTO VETRO L.M. L=23mm
19	GN1327A0 GUARNIZIONE RES. 100X22
20	GRL1010A1 GRIGLIA LATERALE DX/SX CROMATA
21	MG1015B0 TERMINALE MANIGLIA L.MISS/L.MICRO/CHEFFTO
22	PD1001A0 PIEDINO 35X35 H26 PLASTICA+GOMMA GRIGIO
23	TM1005A0 TIMER M12 60 MIN 250V 16A
24	VM1115A0 TAPPO DX CRUSCOTTO COMANDI IN
25	VM1116A0 TAPPO SX CRUSCOTTO COMANDI IN
26	OD1340B0 CRUSCOTTO COMANDI MANUALE INOX L.M. 600
27	TR1100A0 TERMOSTATO REG. 269°C 55.19052.80
28	RC1170A1 DADO M14 H=8 CH=22 INOX
29	RS1130A0 RESISTENZA CIRCOLARE D=230 3 SPIRE
30	TB1815A0 TUBO PE 7,93X4,75 TRASPARENTE
31	TG305 TEGLIA 460x330 PIANA ALLUMINIO
33	TR1140A0 TERM. SIC.BIP. 350°C RIARMO MANUALE
34	VM1025A0 TAPPO NYLON PA66 V2 GRIGIO Ø16
35	VE1005A3 LAMPADA HALOPIN 25W
35	VE1015A1 PORTA LAMPADA SERIE 2 PER LAMPADA
36	VT1195A0 VETRO COPRILAMPADA BOROSILICATO TEMPRATO
38	VE1145A0 CONDENSATORE 3,5 µF 450 Vac 50/60 Hz
39	VE1102A0 CUFFIA COPRI MOTORE IN PLASTICA
41	VII035A1 NOTTOLINO M6x12,5 CON TAGLIO OTT.CROM.FE
42	VM1045B0 TAPPO SUP. DX COLONNINA PORTA
43	VM1046B0 TAPPO SUP. SX COLONNINA PORTA
45	VM1750A0 MORSETTIERA A PETTINE
46	VNI035B1 MOTORE SISME 230 VAC LINE MISS
47	VNI050A2 VENTOLA D=196 H=32 38 PALE INOX DADO M6
48	VT1060A0 VETRO INTERNO 515X414X4 BETFL
49	VT1062A0 VETRO ESTERNO SER. GRIGIO 598X424X5
50	VLI010A0 AFFONDANTE CON FILTRO

51	EL1185A0 RACCORDO A GOMITO J.GUEST Ø8 - Ø8
52	GN1324A0 O-RING GOMMA R4
53	RC1180A3 RIDUZIONE M10X1 FEMM-Ø8 INOX
55	TB1816A0 TUBO PP 6X4 TRASPARENTE
60	ED1070A0 ETICHETTA UNOX ELLISSE 78x33 ARGENTO
61	MNI090B0 MANOPOLA SERIGR. TIMER 0-60 MIN
62	MNI091B0 MANOPOLA SERIGR. TERMOSTATO 80-260°C
63	MNI095A0 GHIERA CON INDICE STAMPATO NECHELATA
64	VE1535A0 LED BIANCO 230V
65	VM1762A0 SUPPORTO LAMPADA INTERNO
66	VE1170A0 SUPPORTO D16 ELLITTICO NICHEL OPACO
67	VE1530A0 GEMMA ELLITTICA AZZURRA TERMOMETRO ORO
68	VM1775A0 TASTO ARGENTO OPACO NUVOLETTA ORO
69	VE1562A0 PULSANTE UNIPOLARE NA
70	GN1055A0 OR 46x2 VMQ 70 ROSSO
71	OH3020A1 DISCO TENUTA ALBERO MOTORE
72	GN1135A2 GUARNIZIONE PORTAMOTORE STAMP.
73	OH3585A0 LAMIERA PROTEZIONE MOTORE ZINCATO L.M.

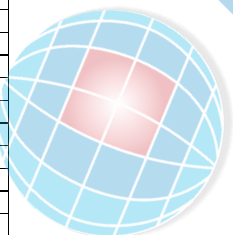

PLATON SERVICE
8 (800) 500-34-41
www.platonservice.com

MOD: XF133-B

Pagina 3

EXPLODED VIEW DISEGNO ESPLOSO



DESCRIPTION

1	OD1275B0
2	OFI085B0
3	OG1112B0 L.M. ARIANNA MANUAL FAN GUARD
4	OH1425B0 LEFT/RIGHT DOOR COLUMN L.M. ARIANNA-ROS
5	OH1455A1 LINE MISS CHAMBER HOLDING BRACKET
6	OH1925B0 ST. STEEL HANDLE TUBE Ext. D=18 Th=1 L=518
7	OH1990A1 EXTERNAL WATER PIPE + STAINLESS
8	OH3743A0 PUMP EL070 SUPPORT
9	MRI000A0 CABLE 3X1,5 H07RN-F MITI,5+K2/3+SCHUKO
10	CR1000A0 HINGE LATCH L.M.
11	CR1015A0 HINGE L.M. ARIANNA
12	EL1055A0 STRAIGHT REDUCTION FROM D=10 TO
13	VM1951A0
14	PM1000A0 PUMP NMEIC+ATT SJP PUMP M10 09.02.060/B
15	GN1065A1 SEAL FOR LAMP GLASS COVER IPURE
16	GN1110A2 DOOR GASKET PROFILE 248 LINE MISS-XCH030
17	OH4820A0 STANDARD BULB SUPPORT '02
18	GN1130A0 LINE MISS INT. GLASS SEAL L=23mm
19	GN1327A0 HEATING ELEMENT GASKET 100X22X0.8
20	GRL1010A1 RIGHT/LEFT LATERAL GRID CHROM.PLATED
21	MG1015B0 L.MISS/L.MICRO/CHEFTOP HANDLE TERMINALS
22	PD1001A0 FOOT 35X35 H26 GREY PLASTIC+RUBBER
23	TM1005A0 TIMER M12 60 MIN 250V 16A
24	VM1115A0 RIGHT PLASTIC LATERAL CAP FOR
25	VM1116A0 LEFT PLASTIC LATERAL CAP FOR CONTROL
26	OD1340B0 L.M. MANUAL 460X330 CONTROL BOARD
27	TR1100A0 269°C ADJUSTABLE THERMOSTAT 55.19052.80
28	RC1170A1 STAINLESS STEEL NUT M14 H=8 CH=22
29	RS1130A0 CIRC.HEAT.ELEMENT D=230 3 TURNS
30	TB1815A0 WHITE PE PIPE 7,93X4,75
31	TG305 TRAY 460x330 FLAT ALUMINIUM
33	TR1140A0 TERM.SIC.BIP. 350°C RIARMO MANUALE
34	VM1025A0 NYLON LID PA66 V2 GREY Ø16
35	VE1005A3 HALOGEN LAMP 33W ENERGY SAVER
35	VE1015A1 LAMP HOLDER SERIE 2 FOR HALOGEN LAMP
36	VT1195A0 BOROSILICATE LIGHT BULB GLASS COVER
38	VE1145A0 CONDENSER 3.5 µF 450 Vac 50/60 Hz
39	VE1102A0 PLASTIC COVER FOR MOTOR L.M. CRI-STE-ARI
41	V11035A1 CHROMIUM PLATED BRASS NUT M6x12,5
42	VM1045B0 RIGHT UPPER LID FOR COLUMN FOR
43	VM1046B0 LEFT UPPER LID FOR COLUMN FOR
45	VM1750A0 TERMINAL BOARD
46	VN1035B1 LINE MISS 230 VAC MOTOR
47	VNT050A2 FAN D=196 H=32 38 STAINLESS STEEL
48	VT1060A0 INNER GLASS 515x414x4 BETFL L.M. ARIANNA
49	VT1062A0
50	VLI010A0

51	EL1185A0 ELBOW CONNECTION J. GUEST Ø8 - Ø8
52	GN1324A0 RUBBER O-RING NBR70/75SH R=4
53	RC1180A3
55	TB1816A0 CLEAR POLYPROPYLENE PIPE 6x4mm
60	ED1070A0 UNOX ELLIPTICAL STICKER 78x33-SILVER
61	MNI090B0
62	MNI091B0
63	MNI095A0
64	VE1535A0 WHITE LED 230V
65	VM1762A0 INNER LAMP SUPPORT
66	VE1170A0 OPAQUE NICKEL ELLIPTICAL SUPPORT D16
67	VE1530A0 BLUE ELLIPTICAL GEM GOLD THERMOMETER
68	VM1775A0 OPAQUE SILVER KEY WITH GOLD "CLOUD"
69	VE1562A0 UNIPOLAR NA PUSH BUTTON
70	GN1055A0 OR 46x2 VMQ 70 RED
71	OH3020A1
72	GN1135A2
73	OH3585A0 ZINCATE MOTOR GUARD PLATE L.M.

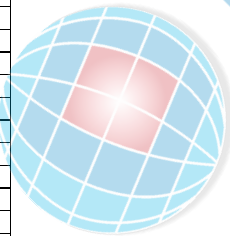

PLATON SERVICE
8 (800) 500-34-41
www.platonservice.com



PLATON SERVICE

8 (800) 500-34-41

www.platonservice.com